



Burnaby Street, Hillsborough, S6 2RA

Offers In Region Of £220,000

3 1 2



Why We Love It

Enjoy the fantastic location, with supermarkets within walking distance, tram stops at your doorstep, and key roads like Penistone Road moments away, providing ease of access to the center and beyond. With plenty of schools nearby and an abundance of parks and green spaces, Burnaby Street offers a convenient and vibrant lifestyle for families and professionals alike.

Why You'll Love It

As you enter through the side door, you're greeted by a spacious and modern lounge to your right, boasting a large window that floods the room with natural light. To your left, the family dining room awaits, featuring French doors that open into the garden, creating an ideal space for seamless indoor/outdoor living. The garden, easy to maintain and of good size, offers a serene retreat.

Back inside, the kitchen, conveniently off-shot from the dining room, presents a modern design with ample storage, facilitating effortless flow. Accessible via the dining room is the cellar, providing additional storage space. Upstairs, discover two well-proportioned bedrooms on the first floor, including a generous double. Completing this floor is a luxurious 4-piece bathroom suite with a corner bath and separate shower—a perfect oasis for relaxation. Venture to the final bedroom, the attic room, offering a bright and open space.

Experience the perfect blend of modern convenience and cosy comfort at Burnaby Street. With its spacious rooms, seamless indoor/outdoor living, and convenient location, this charming end terrace offers a delightful retreat in the heart of Hillsborough. Whether you're relaxing in the garden, enjoying the luxurious bathroom, or exploring the nearby amenities and green spaces, Burnaby Street invites you to embrace a vibrant lifestyle in Sheffield.



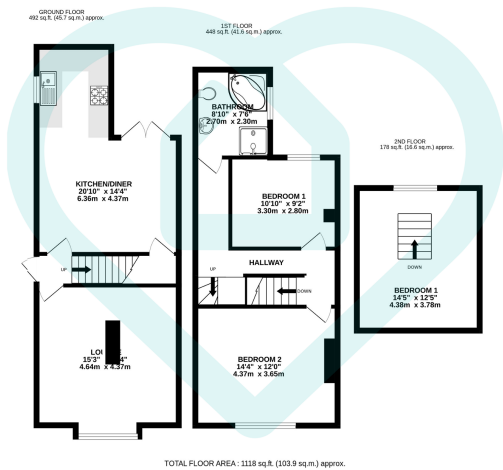

This floor plan is for illustrative purposes only. All measurements and layouts are approximations and do not necessarily capture the precise specifications of the property. No responsibility is taken for any error, omission, or misstatement. We always recommend viewing in person to confirm the exact floor plan of a property. Made with Metropix.



- On Street Parking
- Large Living Space
- 3 Bedrooms
- Modern Kitchen
- Unbeatable Transport Links
- Key Road Access
- Schools Near By
- Plenty of Local Amenities
- Greenspace
- Ease of Access to the City Centre

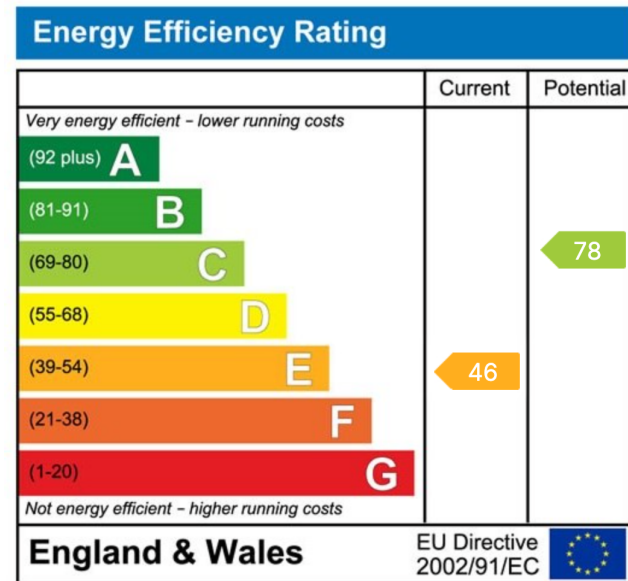

Sales | Lettings | New Homes

VAT Reg Number: 191 3588 84
 Company Reg Number: 08610489
 Company Reg Address: 67 Middlewood Road, Hillsborough, Sheffield, S6 4GX.

The MorfittSmith Building
 67 Middlewood Road
 Hillsborough
 Sheffield
 S6 4GX

Get in touch - arrange an appointment

- 0114 232 1764
- sales@morfittsmith.co.uk
- lettings@morfittsmith.co.uk
- newhomes@morfittsmith.co.uk
- www.morfittsmith.co.uk

- @MorfittSmith
- @MorfittSmith
- MorfittSmith Estate & Letting Agent